



OD-Mounted Cutting and Beveling machine

Concentrate On Manufacturing
Beveling Machine



FEATURES:

Lower axial and radial clearance, light weight suitable for working at narrow and complicated site
Can separate to two half, it's easy for the pipe when two end not open.
The machines do the cutting and beveling simultaneously
The tool not only can process carbon steel, stainless steel and alloy pipe with U, V welding seam but also can process convex flange welded.

APPLICATION RANGE:

They are widely used in the fields of petroleum, chemical, natural gas, power supply construction, boiler and nuclear power, such as the project of west gas transporting to east

DRIVING TYPE:

Electric-OCE, Pneumatic-OCP, Hydraulic-OCH, Numerical Controller-OCS

Power Supply: 380V 3PH 50/60HZ 10MPa@25L/Min
Powerful drive, High efficiency Stable Performance Low noise Adjustable speed
Ideal for heavy wall & large size pipe
(Non-standard voltage can be customized)



OCH(Hydraulic)



OD-Mounted pipe Cutting and Beveling machine

OD-Mounted Electric Series

- Power Supply: 220-240V 1PH50-60HZ
- Motor Power: 1.5-2KW



OCE(Electric)



Aluminum Alloy



OCP(Pneumatic)



Power Supply: 0.8-1.0MPa@1000-2000L/min
Explosion Proof
Stable Performance
Simple structure makes easy to maintenance
Occasionally overload won't burn

SPECIFICATION:
Power supply: 220V 1Ph 50HZ
Output torque: 15Nm
Power: 1.5-4KW



OCS(CNC)



Processing Drawing

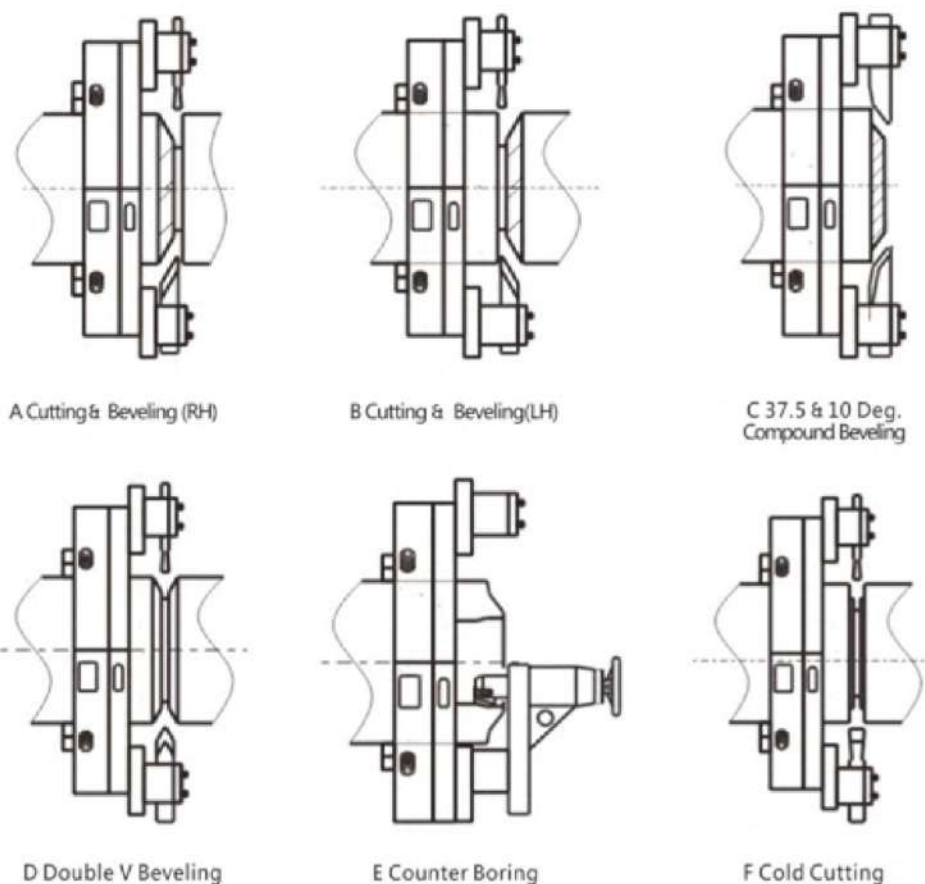

Processing Schematic

Model	Spec.	Capacity(OD mm)		Wall thickness		Rotation Speed
		(mm)	OD (inch)	标准 Standard	重载 Heavy-duty	
电动 OCE	89	Φ25-89	1"-3"	≤30	-	42r/min
	159	Φ50-159	2"-5"	≤30	-	20r/min
	168	Φ50-168	2"-6"	≤30	-	18r/min
	230	Φ80-230	3"-8"	≤30	-	15r/min
	275	Φ125-275	5"-10"	≤30	-	14r/min
	305	Φ150-305	6"-10"	≤30	≤110	13r/min
	325	Φ168-325	6"-12"	≤30	≤110	13r/min
	377	Φ219-377	8"-14"	≤30	≤110	12r/min
	426	Φ273-426	10"-16"	≤30	≤110	12r/min
	457	Φ300-457	12"-18"	≤30	≤110	12r/min
气动 OCP	508	Φ355-508	14"-20"	≤30	≤110	12r/min
	560	Φ400-560	16"-22"	≤30	≤110	12r/min
液压 OCH	610	Φ457-610	18"-24"	≤30	≤110	11r/min
	630	Φ480-630	20"-24"	≤30	≤110	11r/min
数控 OCS	660	Φ508-660	20"-26"	≤30	≤110	11r/min
	715	Φ560-715	22"-28"	≤30	≤110	11r/min
变频 OCM	762	Φ600-762	24"-30"	≤30	≤110	11r/min
	830	Φ660-813	26"-32"	≤30	≤110	10r/min
	914	Φ762-914	30"-36"	≤30	≤110	10r/min
	1066	Φ914-1066	36"-42"	≤30	≤110	10r/min
	1230	Φ1066-1230	42"-48"	≤30	≤110	10r/min
	1430	Φ1230-1430	48"-56"	≤30	≤110	8r/min

Note: Non-standard machines are available according to customers' requirement.

VICTORQ

OD-Mounted pipe Cutting and Beveling machine

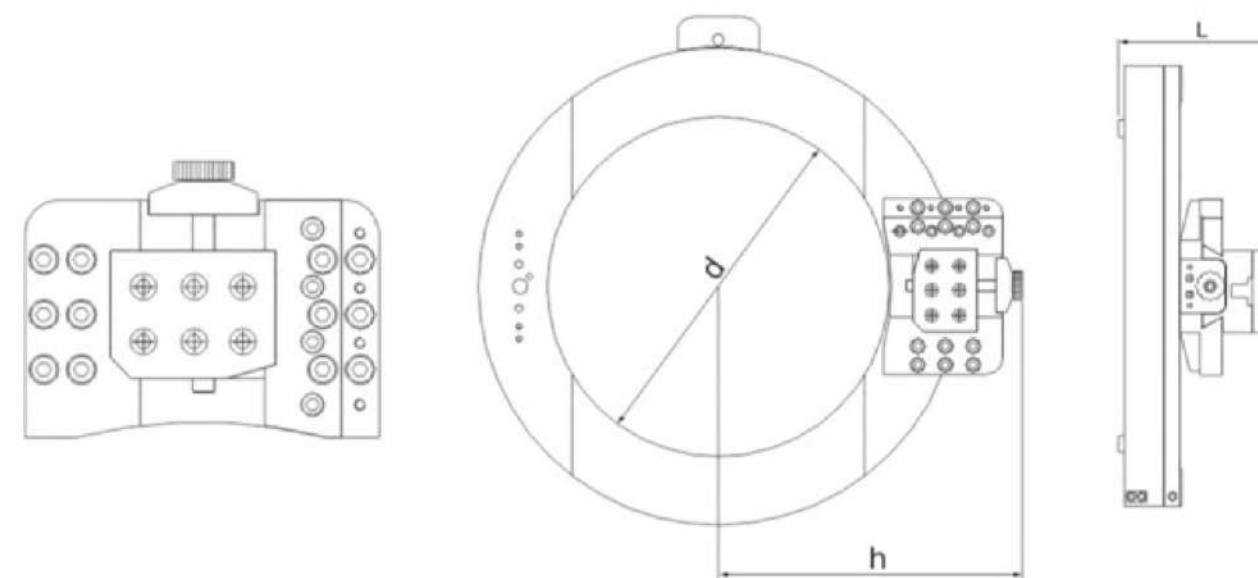

Axial & Radial Clearance

Model	Spec.	"d" DIM(mm)	"h" DIM(mm)	"L" DIM(mm)
OCE	89	90	132	159
	159	160	217	171
	168	170	227	171
	230	232	253	171
	275	280	275	171
	305	308	290	171
	325	330	300	171
	377	380	328	171
	426	430	351	172
	457	460	367	172
OCP	508	510	396	181
	560	560	420	182
OCH	610	612	445	182
	630	632	454	182
OCM	660	670	475	182
	715	715	495	185
	762	765	520	185
	830	830	555	187
	914	915	592	194
	1066	1070	619	194
	1230	1235	777	207
	1430	1438	877	220

Bridge Tool Slide



The bridge tool slide accessory is used for faang, counterboring, inside beveling and beveling an open pipe end, especially for the heavy wall thickness pipe. The slide mounted onto one OD-Mounted machine and "bridge" the end of the pipe. The bridge tool slide uses a single point tool and is available with beveling templates for various form contours.

- Each size available for 3 model OD-Mounted machine
- Bevel, Compound beveling, Inside beveling, J-Prep, and counterbore
- No limit of wall thickness, material: Carbon steel, alloy steel, stainless steel or other pipe.
- Tool feed automatically
- Complete with counterbore/ID beveling tool, ID beveling angle available for adjust
- Feed wheel, worm wheel and worm covert designed, make operation more safe



Data Parameter



Processing Schematic

Model	Spec.	Capacity(OD mm)		Wall thickness	Rotation Speed
		(mm)	OD (inch)		
OCE	275	Φ 125-275	5"-10"	≤80	14r/min
	305	Φ 150-305	6"-10"	≤80	13r/min
	325	Φ 168-325	6"-12"	≤80	13r/min
	377	Φ 219-377	8"-14"	≤80	12r/min
	426	Φ 273-426	10"-16"	≤80	12r/min
	457	Φ 300-457	12"-18"	≤80	12r/min
OCP	508	Φ 355-508	14"-20"	≤80	12r/min
	560	Φ 400-560	16"-22"	≤80	12r/min
OCH	610	Φ 457-610	18"-24"	≤80	11r/min
	630	Φ 480-630	20"-24"	≤80	11r/min
OCS	660	Φ 508-660	20"-26"	≤80	11r/min
	715	Φ 560-715	22"-28"	≤80	11r/min
	762	Φ 600-762	24"-30"	≤80	11r/min
	830	Φ 660-813	26"-32"	≤80	10r/min
	914	Φ 762-914	30"-36"	≤80	10r/min
	1066	Φ 914-1066	36"-42"	≤80	10r/min
	1230	Φ 1066-1230	42"-48"	≤80	10r/min
	1430	Φ 1230-1430	48"-56"	≤80	8r/min

More Choices, More Practical



Fluctuate tracing tool slide

To process and adjust according to pipe diameter, ellipse pipe



Heavy duty tool side

To process thickness≤110

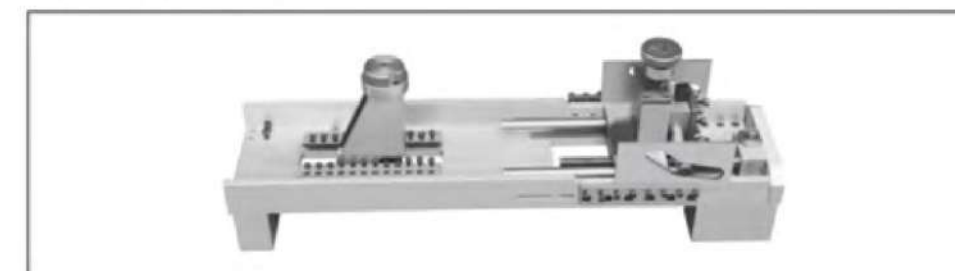

Bridge tool side: To process thick wall pipe and flange facing



Chuck type self-centering Cutting and beveling machine



SOCE



SOCP

Chuck type(High-Efficiency) self-centering Cutting and beveling machine

Adopt high strength & precision split frame ring structure, apply for cut and bevel work for different pipe, especially for batch working of cutting and beveling, get the high efficiency.

Various of driven options: pneumatic, electric or hydraulic.

- Self-centering, no need adjust the concentricity & perpendicularity manually. Four clamp install synchronously and high effect.
- New clamping type, save the step of replace expanding block.
- Adopt new synchronous feeding mechanism, feeding uniformity, tool bits has longer working life.
- Easy set-up, operation and maintain.
- Cutting & beveling finished at same time, high working effective.
- Cold working, no spark, won't make the material affected.
- Perfect working precision, no burrs
- Well-adapted, install split, you can make the speed adjust depend on the working conditions.

Data Parameter



Processing Schematic

Model	Spec.	Capacity(OD mm)		Wall thickness	Rotation Speed
		(mm)	OD (inch)		
SOCE	168	Φ50-168	2"-6"	≤30mm	18r/min
	230	Φ80-230	3"-8"	≤30mm	15r/min
	275	Φ125-275	5"-10"	≤30mm	14r/min
SOCP	305	Φ150-305	6"-10"	≤30mm	13r/min
	325	Φ168-325	6"-12"	≤30mm	13r/min
SOCH	377	Φ219-377	8"-14"	≤30mm	12r/min
	426	Φ273-426	10"-16"	≤30mm	12r/min
SOCM	457	Φ300-457	12"-18"	≤30mm	12r/min
	508	Φ355-508	14"-20"	≤30mm	12r/min
	610	Φ457-610	18"-24"	≤30mm	12r/min

ON-SITE PRDCESS





Internal expansion type pipe beveling machine

Concentrate On Manufacturing
Beveling Machinery



ISE-120

FEATURES:

- This series is ID-mounted pipe beveling machine with light weight, compact design.
- There are 12 art No. for option.
- Easy and quickly set-up self centered and squared to the bore.
- The tool not only can process carbon steel, stainless steel and alloy pipe with U, V welding seam but also can process convex flange welded.
- Fast precision, on-site beveling, the bevel angle by your required.
- This series available for electric and pneumatic driven.

APPLICATION RANGE:

They are widely used in the fields of petroleum, chemical, natural gas, power supply construction, boiler and nuclear power, such as the project of west gas transporting to east

DRIVING TYPE:

Electric-ISE. Pneumatic-ISP



Internal expansion type electric pipe beveling machine

Power Supply: 220-240V 1PH 50-60HZ
Motor Power: 1.2-2KW



ISE-30



ISE-80

Concentrate On Manufacturing
Beveling Machinery

ISE-159



ISE-252-1



ISE-352-1



ISM-159



Internal expansion type
Pneumatic pipe beveling machine

Power Supply: 0.8-1.0 MPa,1000-2000L/min
Explosion Proof
Stable Performance
Simple structure makes easy to maintenance
Occasionally overload won't burn



ISP-159

ISP-426-1

Data Parameter

Beveling Tool Bits

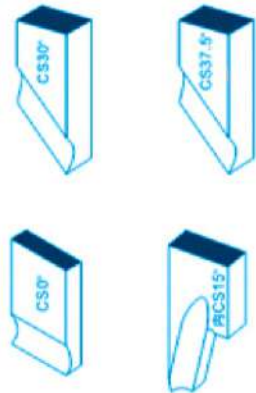

ISE-630-1

Specification

Model	Spec.	Capacity(ID mm)	Wall thickness	Rotation Speed
		(ID mm)		
ISE	30	Φ18-28	≤15	50r/min
	80	Φ28-76	≤15	55r/min
	120	Φ40-120	≤15	30r/min
	159	Φ65-159	≤20	35r/min
ISP	252-1	Φ80-240	≤20	16r/min
	352-1	Φ150-330	≤20	14r/min
ISM	426-1	Φ250-426	≤20	12r/min
	630-1	Φ300-600	≤20	10r/min
	850-1	Φ600-820	≤20	9r/min



Internal expansion type pipe beveling machine

Internal expansion type pipe beveling machine

Main Performance:

This series is ID-Mounted pipe beveling machine, with the advantage: Easy operation, light weight. A draw nut is tightened, which expands the mandrel blocks up a ramp and against the ID surface for positive mounting, self centered and squared to the bore. It's can work with various material pipe, beveling angle as per your required.



ISE-352-2



ISE-252-2



ISE-252-2

Cam-Type self-centering cutting and beveling machine



Cam-Type (High-Efficiency) self-centering cutting and beveling machine

- Self-Centering, no need adjust work of concentricity & perpendicularity.
- Compact structure and good appearance, high strength aluminum body
- Adopt new synchronous feeding mechanism, feeding uniformity, tool bits has longer working life.
- Easy set-up, operation and maintain.
- Cutting & beveling finished at same time, high working effective.
- Cold working, no spark, won't make the material affected.
- Perfect working precision, no burrs.
- Well-adapted, you can make the speed adjust depend on the working conditions.

Model	Spec.	Working Range	Thickness	Speed	Weight
SCB	63	Φ14~63mm	≤12mm	30~120r/min	13kg
SCB	114	Φ63~114mm	≤12mm	30~120r/min	16kg

Orbital pipe cutting machine



Specification

Model	H120	H182	H230	H325
Pipe OD	1.5"-4.5"	3"-6"	6"-9"	8.5"-12.5"
	20-120mm	85-182mm	150-230mm	215-325
Wall Thickness	0.04"-0.22"	0.08"-0.4"	0.08"-0.4"	0.08"-0.4"
	1-7mm	2-10mm	2-10mm	2-10mm
Motor Blade RPM	1600w	1600w	1600w	1600w
	150-250	150-250	150-250	150-250
V/Hz	110/220v	110/220v	110/220v	110/220v
	50/60Hz	50/60Hz	50/60Hz	50/60Hz
Net Weight	75kg	90kg	110kg	130kg
	165lb	198lb	242lb	286lb
Application	Thin-wall stainless-steel tubes Stainless steel pipes Low and unalloyed steel Casting materials, non-ferrous metal Copper, aluminum and diastolic pipes			



OD-Mounted Auto-feed Pipe Beveling Machine



ISO-63C

Main Performance

This series machine adopts METABO motor, main applied in the field of power plant pipeline installation, chemical industry, shipbuilding, especially pipeline prefabrication and low clearance on site working, such as maintain thermal power auxiliary equipment, boiler pipe valve.

Feature:

- (1) Ingenious centering device, easy for process various of pipe size
- (2) Compact design, good rigidity
- (3) Tool feed/back automatically

Model	Range	Max. Depth	Max. Width	Max. Length
ISO-63C	Φ28-63	≤12mm		28.32.38.42.45.51.54.57.60.63
ISO-76C	Φ42-76			42.45.51.54.57.60.63.68.76
ISO-89C	Φ63-89			63.68.76.83.89
ISO-114C	Φ76-114			76.83.89.95.102.108.114

Chain-Type hydraulic pipe cutting machine



Specification

Model	ZYQ200-1200
Cutting pipe scope	DN200-3000mm
Cutting speed	90mm/min
Maximum percent depth	32mm
Milling speed	125r/min
Working pressure	10MPa
Weight	37kg



Plate beveling machine



Data Parameter

Specification

Model	Spec.	Capacity(ID mm)	Wall thickness	Rotation Speed
		(ID mm)		
ISE	252-2	Φ80-240	≤75	16r/min
	352-2	Φ150-330	≤75	14r/min
ISP	426-2	Φ250-426	≤75	12r/min
	630-2	Φ300-600	≤75	10r/min
ISM	850-2	Φ600-820	≤75	9r/min

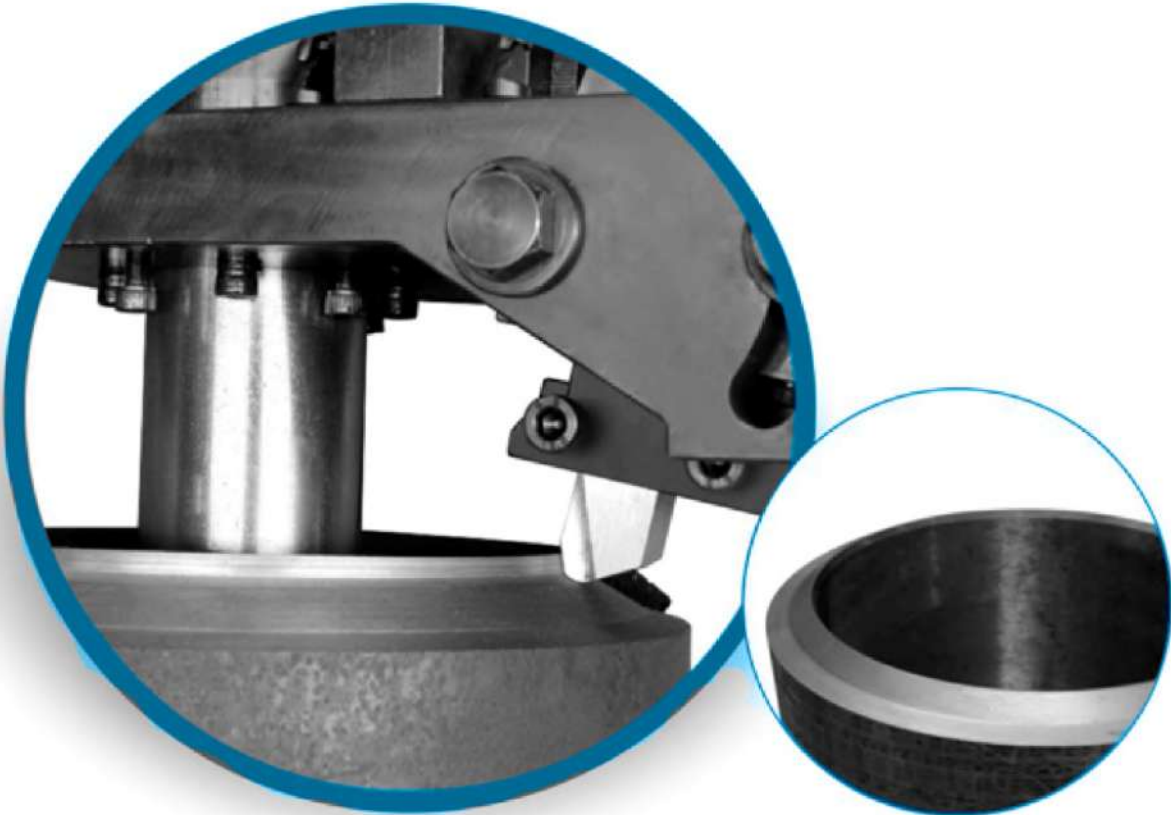

Self-centering pipe cutting
and beveling machine

- Adopt high strength & precision ring structure, apply for cutting and beveling pipe, especially for batch working of cutting, beveling for thin wall thickness pipe.
- Adopt METABO motor: low noise, long life, stable performance and perfect speed adjustable function, with CE certificate.
- Power supply: 220-240V 1PH 50/60HZ

Automatic plate beveling machine PB-60L



The PB-60L edge milling machine convenient movement and simple operation. The finish of the groove is as high as Ra3.2~6.3. It is suitable for small factories. The milling machine is equipped with commonly used CNC blades to make the customers use the cost more cheaply.

Power	AC 380V 50HZ	Clamp Thickness	6~60mm
Total	3400W	Clamp Width	> 80mm
Spindle Speed	1050r/min	Clamp Length	> 300mm
Feed Speed	0~1500r/min adjustable	Worktable Height	820~860mm
Bevel Width	1~55mm	Net Weight	220kg
Single Bevel Width	1~20mm	Processing materials	Carbon Steel Stainless Steel Aluminum alloy Composite Plate
Bevel Angle	0°~90° adjustable		

Multifunctional groove machine PB-10



PB-10 multifunctional groove machine is a manual operation of electric tools, this machine is suitable for processing before welding groove (can be processed into K, V, X, Y type groove), can be carried out on the plate groove processing and metal materials burring, etc. Its versatility and flexibility and can be a lot of improve the efficiency of work and make it become the attractive device, the machine structure is compact, to where the environment is complex and difficult to machining operations.

Voltage	220~240V	Beveling Width	1~15mm (Q235)
Power	2000W	security	Soft start
Speed	2500~7500 r/min	Tool Bit Qty	4
Bevel Angle	30° 37.5° 45° (standard 30°)	Weight	7Kg



Pneumatic chamfering machine PB-R3



PB-R3 chamfering machine has large engine power and stable operation. USES carbide blade, there are eight working face are available, and the use of safe, stable size, blades, long life, high cutting efficiency, very suitable for shipbuilding, framework, a bridge in areas such as the edge of the sheet metal, holes, chamfer edges of R, C for chamfering.

Dimension	150, 160 Underpan 150, Height 160
Tool Bits Qty	3pcs
Minimum Working radius	R16
Milling Angle	R 1~3
Plate Thickness	≥ 9mm
Weight	3.9kg
Milling speed	3m/min
Air Hose I.D	≥ 10
Air pressure	0.4~0.63MPa

Plate beveling machine PBM-15



PBM-15 groove machine is specially designed for plate groove and chamfer, and it is a hand-propelled groove processing tool. It is suitable for chamfering metal plate and groove processing before welding. Light weight (compared with similar products), small vibration, easy to operate, safe and reliable.

Maximum milling width	1~15mm (adjustable)
Milling Angle	30°~60° (adjustable)
Weight	18KG
Voltage	380V(220V)
Frequency	50Hz
Power	1.1KW
Speed	2870r/min



Table Model pipe cutting and beveling machine

- Auto feed, cutting and beveling at the same time.
- Suitable for pipeline, Out-Mounted.
- Selectable operational table and pipe carrier can be used to piece together into a logistics system.



TCQ

Orbital Cold Pipe Cutting Machines

- use a few seconds to finish the cut with one single rotation around the pipe.
- Compact design, small space.
- Used for Carbon Steel, Stainless Steel, Alloy Steel, Non-ferrous, Engineering plastic and Cast steel.
- Metabo drive, safe and efficient.
- Will not influence the pipe material.



OCQ

Flange Facing Machine



WFS-610



WFP-610

Main Performance

Flange Facer Machine are Multi-Function series machine. The Product make up with three parts, have four clamp support, Internal mounted, small working radius. The novel tool holder design can be rotated 360 degrees, high efficiency. Suitable for all types of flange facing, seal groove machining, weld prep and counter boring. It is special for pipe, valve, pump flanges etc.

Feature:

1. Compact structure, Light weight, easy to carry out.
2. Have scale of feed handwheel, improve feed accuracy
3. Automatic feeding in the axial direction and the radial direction, high efficiency
4. Horizontal, vertical, inverted, tilt etc, any direction both can be processed.
5. Can process flat face, water line, Continuous groove, RTJ groove etc
6. Driven: Pneumatic, Hydraulic, CNC

Model	Spec.	Facing Range (O.D)	Mounting Range (I.D)	Tool Feed Stroke	Tool holder Swivel Angle	Rotation Speed
WFP	610	50-610mm	50-508mm	50mm	+/-30°	0-42r/min
	1000	153-1000mm	145-813mm	102mm	+/-30°	0-33r/min
WFH	1650	500-1650mm	500-1500mm	102mm	+/-30°	0-22r/min
	2000	762-2000mm	604-1830mm	102mm	+/-360°	0-20r/min
WFS	3000	1150-3000mm	1120-2800mm	102mm	+/-360°	3-12r/min

Note : Non-Standard machines are available according to customer's requirement.

● Stationary plate beveling machine PB-10D



PB-10D small table plate milling machine. The finish of the groove is as high as Ra3.2-6.3, and the machine is suitable for high hardness materials such as stainless steel and other materials. It includes groove processing for high degree of smoothness of beveling machine.

PB-10D			
Power	AC 380V 50Hz	Bevel Angle	30°-60° (adjustable)
Total	2000W	Clamp Thickness	2-40mm
Spindle Speed	1440r/min	Clamp width	> 20mm
Feed Speed	0-1500r/min (adjustable)	Net Weight	80kg
Bevel Width	1-18mm	Processing materials	Carbon Steel , Stainless Steel , Aluminum alloy Composite Plate
Single Bevel Width	1-10mm		

● Automatic plate beveling machine PB-80



The PB-80 edge milling machine convenient movement and simple operation. The finish of the groove is as high as Ra3.2-6.3. It is suitable for small factories. The milling machine is equipped with commonly used CNC blades to make the customers use the cost more cheaply.

PB-80			
Power	AC 380V 50Hz	Clamp Thickness	6-60mm
Total	4800W	Clamp width	> 100mm
Spindle Speed	750-1440r/min adjustable	Process Length	> 300mm
Feed Speed	0-1500r/min (adjustable)	Worktable Height	820-860mm
Bevel Width	1-60mm	Net Weight	270kg
Single Bevel Width	1-20mm	Processing materials	Carbon Steel , Stainless Steel , Aluminum alloy Composite Plate
Bevel Angle	0°-60° (adjustable)		

● Automatic plate beveling machine PB-60



The PB-60 edge milling machine convenient movement and simple operation. The finish of the groove is as high as Ra3.2-6.3. It is suitable for small factories. The milling machine is equipped with commonly used CNC blades to make the customers use the cost more cheaply.

PB-60			
Power	AC 380V 50Hz	Clamp Thickness	6-40mm
Total	3400W	Clamp Width	> 100mm
Spindle Speed	1050r/min	Clamp Length	> 300mm
Feed Speed	0-1500r/min (adjustable)	Worktable Height	820-860mm
Bevel Width	1-45mm	Net Weight	250kg
Single Bevel Width	1-15mm	Processing materials	Carbon Steel , Stainless Steel , Aluminum alloy Composite Plate
Bevel Angle	10°-60° (adjustable)		

● Automatic plate beveling machine PB-60R



PB-60R			
Power	AC 380V 50Hz	Clamp Thickness	6-60mm
Total	3400W	Clamp Width	> 100mm
Spindle Speed	1050r/min	Clamp Length	> 300mm
Feed Speed	0-1500r/min (adjustable)	Worktable Height	700-760mm
Bevel Width	0-55mm	Net Weight	225kg
Single Bevel Width	10-15mm	Gross Weight	275kg
Bevel Angle	10°-60° (-10°-60°)	Processing materials	Carbon Steel , Stainless Steel , Aluminum alloy Composite Plate

ZHTW HOLLOW HYDRAULIC TORQUE WRENCH



- 1.700 bar maximum working pressure.
- 2.The material is aluminum titanium alloy , high strength , light weight
- 3.The compact design is made to fit in small spaces.
- 4.Reaction arm can adjust 360°direction , suitable for any position.
- 5.360° multi-positional swivel quick release couplings.
- 6.Constant torque output provide high precision in whole working operation.
- 7.The finish special surface treatment make wrench not easy to rust
- 8.Torque accuracy: + - 3%, repeatability 100%



Model	ZHTW-2		ZHTW-4		ZHTW-8		ZHTW-14		ZHTW-30
Torque	232-2328	241-2414	585-5858	647-6474	1094-10941	1177-11774	1852-18521	4188-41882	4459-44593
Hex Size mm	19-55	60	34-65	70-80	41-95	100-105	50-117	110-155	160-175
Cylinder Kg	1	1	2	2	3.3	3.3	5.5	11.4	11.4
Link Kg	1.6	1.7	4.4	4.6	8	8.4	11.6	29	30

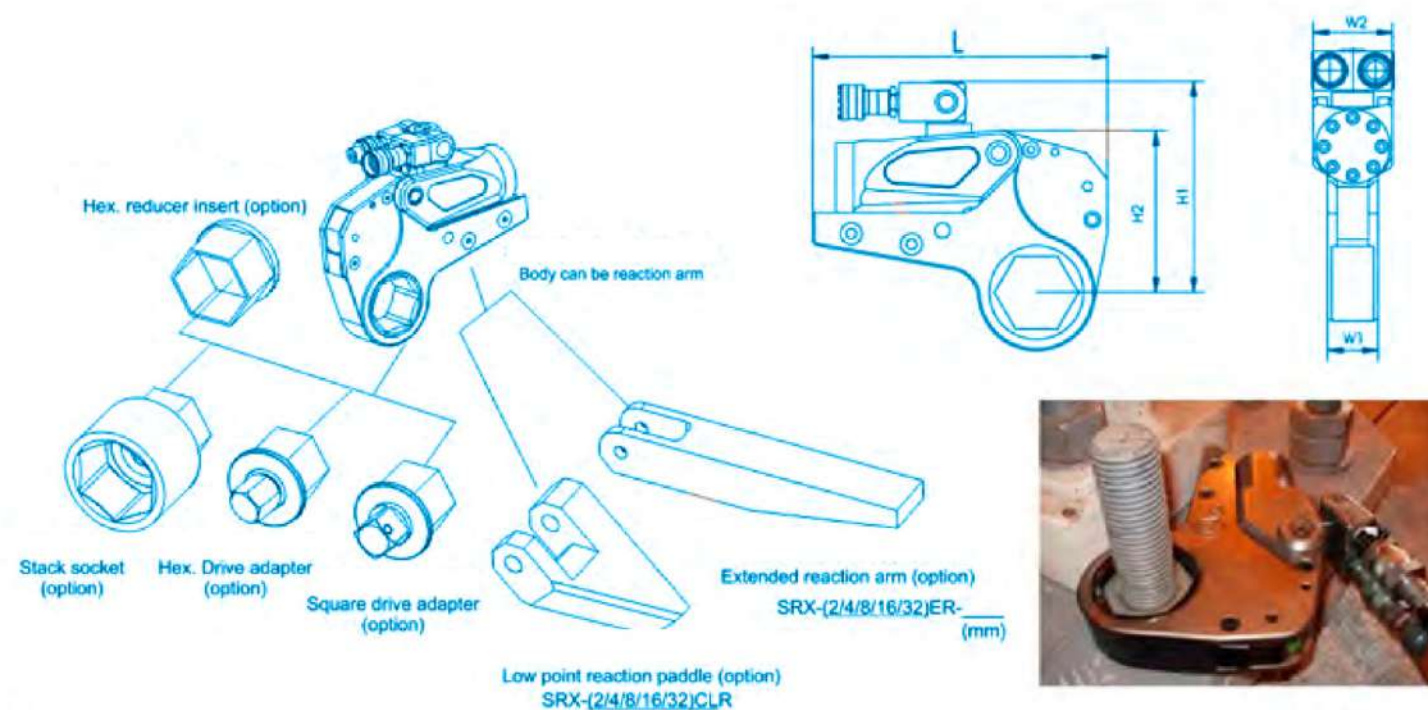

HYB-E HYDRAULIC TORQUE WRENCH PUMP- ELECTRIC

Hydraulic Electric/Torque Wrench Pump

- ※ Compact ,automatic three stage flow.
- ※ Applicable on two wrenches simultaneously.(torque wrench can match with another 4 hydraulic torque wrench work at the same time)
- ※ Tubular steel lifting/protective hoops.
- ※ High precision pressure gauge.
- ※ Infinitely variable pressure adjustment between 40-700bar.
- ※ Configured for continuous operations.
- ※ Max operation heat 70.
- ※ Heat Exchanger Kit : Design air cooling to avoid pump overheating and costly repair from long work periods.

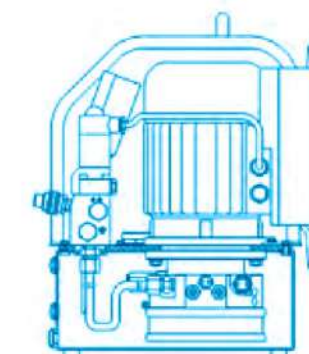
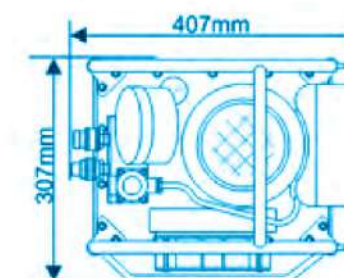
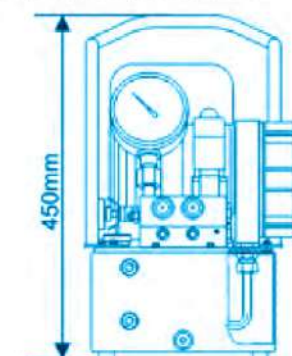

HYB-P HYDRAULIC TORQUE WRENCH PUMP- PNEUMATIC

Hydraulic Electric/Torque Wrench Pump

- ※ Compact ,automatic three stage flow.
- ※ Applicable on two wrenches simultaneously.(torque wrench can match with another 4 hydraulic torque wrench work at the same time)
- ※ Tubular steel lifting/protective hoops.
- ※ High precision pressure gauge.
- ※ Infinitely variable pressure adjustment between 40-700bar.
- ※ Configured for continuous operations.
- ※ Air press: 4-8bar.



Model	Rpm (r/min)	Motor kw(hp)	Voltage /Air	(bar)			(L/min)			Oil tank (L)	Usable oil (L)	Weight (kg)	Power
				L	M	H	L	M	H				
HYB-E	2800	1.1	220/50 (V/Hz)	100	250	700	7	1.6	0.8	8	7	29	Source
HYB-P	2800	1.1	4-8 bar	100	250	700	7	1.6	0.8	8	7	20.5	Air

Portable Multi-Function Line Boring Machine



Main Performance

The Line Boring is a high-efficiency series of machine tools. It is special equipment for processing deep holes in cylinders and hydraulic cylinders. This machine is equipped with a rotating structure design and automatic feeding device with high precision. The machine is widely used in the processing and repair of excavators, loaders, crawler cranes and large marine cranes.

Feature:

1. Alloy Steel Body, Compact structure, Light weight, easy to carry out.
2. Small working radius, it can be adapted to variety of the narrow space, high-altitude complex processing needs.
3. Boring bar is made of high-intensity alloy steel, high strength
4. Can selected different connect head, can achieve different processing. For example, pipe face processing, flanges face processing, bore weld etc.

Model	Spec.	Boring Diameter	Rotation Speed	
LBH	50	55-400 mm	0-118 r/min	2500/3000/3500/4000/4500mm
	60	65-600 mm	0-118 r/min	
	90	100-800 mm	0-78 r/min	
	110	180-900 mm	0-62 r/min	
	150	220-1000 mm	0-55 r/min	
LBS	200	380-1200 mm	0-38 r/min	
	300	460-1600 mm	0-28 r/min	

Note : Non-Standard machines are available according to customer's requirement.

SHTW SQUARE HYDRAULIC TORQUE WRENCH



steel boot

Button change square driver

1. 700 bar maximum working pressure.
2. The material is aluminum titanium alloy, high strength, light weight, easy to carry.
3. Reaction arm can adjust 360° direction, suitable for any position.
4. Push button design can make change drive more convenient.
5. Hydraulic piston and power head are small, compact structure, small radius.
6. Constant torque output provide high precision in whole working operation.
7. Torque accuracy: + - 3%, repeatability 100%

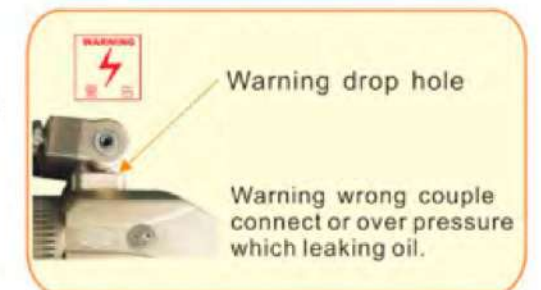

Model	SHTW-1	SHTW-3	SHTW-5	SHTW-8	SHTW-10	SHTW-15	SHTW-20	SHTW-25	SHTW-35
N.m Torque	183-1837	451-4512	752-7528	1078-10780	1551-15516	2063-20627	2666-26664	3472-34725	4866-48666
Bolt size	16-36	22-48	27-56	30-64	36-72	39-80	42-90	48-100	64-120
Kg Weight	2	4	7	9.1	13.1	21	25	31	45
Square drive	3/4"	1"	1-1/2"	1-1/2"	1-1/2"	2-1/2"	2-1/2"	2-1/2"	2-1/2"

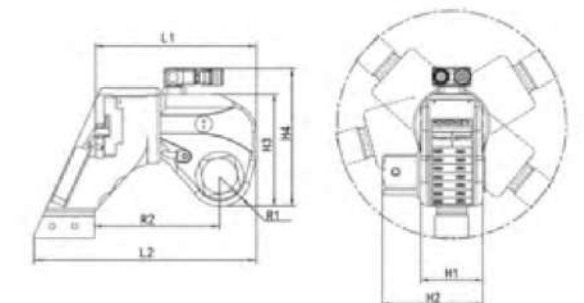
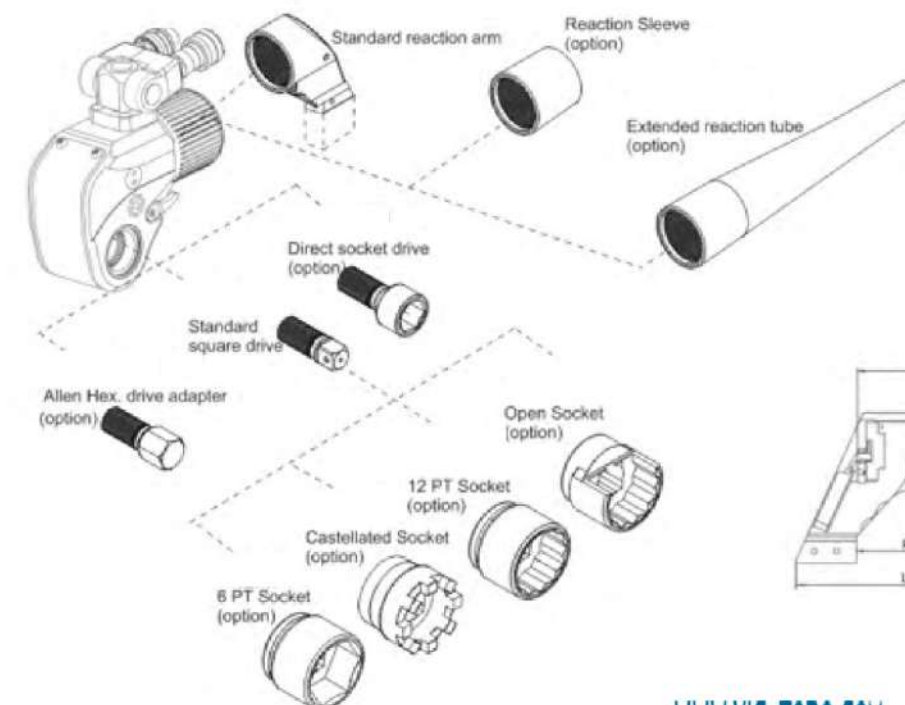

CG1 Serial Portable Semi-automatic
Straight line Flame Gas Cutting Machine

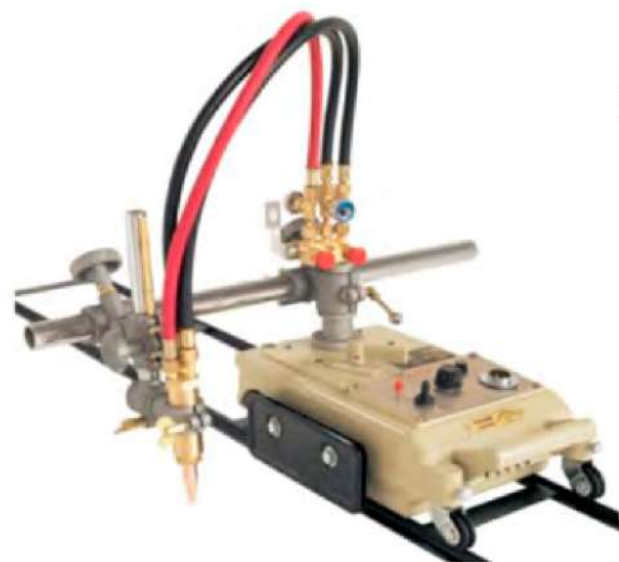

Product Description

- 1. Mainly use Medium pressure acetylene and high pressure oxygen as fuel, also, it can use propane
- 2. Muti-functional. It can used to cut carbon steel, low alloy steel, and medium thickness plate, pipe and some special stainless steel or plastic material
- 3. The roughness of the cutting surface can be 12.5 , and normally , after cutting, the surface don' t need to do any other cutting process
- 4. Cutting range: the plate more than 5 mm ; diameter of pipe:200mm-2000mm (customized)
- 5. Methods of Cutting: linear cutting, circular cutting, incline cutting, and V shape cutting
- 6. Advantages:
 - 1. Adopting thyristor speed control, the machine walks stably.
 - 2. The machine is made by high strength aluminum alloy, so it has long life span
 - 3. The cutting torch can be changed freely by your need
 - 4. The machine is easy to operate, and has compact structure , and safe use, and short auxiliary time, so it is high effective
 - 5. Mainly for linear cutting, and it can use 45 degree bevel cutting

Technical Parameter

Model No.	CG1-30A	CG1-100A	CG1-30B	CG1-100B
Supply Voltage	AC220V/50HZ			
Cutting Thickness	6-100 mm			
Cutting Speed	50-750 mm/min			
Dia.Of.Circle Cutting	200-2000 mm			
Main Body Dimension	470*230*240 mm			
Rail Dimension	1800*200*40 mm			
Weight(main body + rail)/kg	16+12	17.5+12	16+12	18.5+12

PIPE GROOVE MACHINE

WT-50 PIPE GROOVING MACHINE

Product Features

Pipe threading machine is powered by a quiet induction motor, 2-speed gear box.
Capacity: ½"-2"
Motor: 750W Induction reversible motor, single phase, 50~60 Hz,220V (230V, 240V available)
Spindle Speed: 24 RPM for ½"-2"
Switch: ON/OFF switch.
Gear Housing: Aluminum
Body: Casting Aluminum & Iron
Die head: Quick-open type or Automatic type ½"-2"
Dies Included: ½"-¾", 1"-2"
Screw Threads: NPT /BSPT
Dies Material: Alloy standard, (HSS dies optional)
Chuck: Speed chuck with replaceable rocker-action jaws.
Rear Centering Device: Cam-action turns with chuck.
Oiling System: Through-the-head, with integral oil reservoir. Self-priming, constant-flow
Support Bar: Heavy-duty
Chuck: Speed chuck with replaceable rocker-action jaws.



Technical parameters:

Model	Size	Power	Voltage	Spindle speed	GW./NW.	Packigage dimension
WT-50	½"-2" M10-M-24	750W	220V,50HZ	23RPM	75KG/62KG	65*41*52cm

WT-100 PIPE GROOVING MACHINE

Product Features

Capacity: ½"-4" (DN 6mm-100mm)
Motor: 750W Induction reversible motor, single phase, 50~60 Hz, 220V (230V, 240V available)
Spindle Speed: 24 RPM for ½"-2", 10 RPM for 2 ½"-4" (No load)
Switch: ON/OFF switch. (Reverse switch and Foot switch are optional)
Gear Housing: Aluminum
Body: Casting Aluminum & Iron
Die head: Quick-open type or Automatic type ½"-2", and Automatic type 2 ½"-4"
Dies Included: ½"-¾", 1"-2", 2 ½"-3",2 ½"-4"
Screw Threads: NPT /BSPT
Dies Material: Alloy standard, (HSS dies optional)
Chuck: Speed chuck with replaceable rocker-action jaws.
Rear Centering Device: Cam-action turns with chuck.
Oiling System: Through-the-head, with integral oil reservoir. Self-priming, constant-flow
Support Bar: Heavy-duty
Chuck: Speed chuck with replaceable rocker-action jaws.



Technical parameters:

Model	Size	Power	Voltage	Spindle speed	GW./NW.	Packigage dimension
WT-100	½"-4"	750W	220V/380V, 50HZ	18/6RPM	170KG/150KG	106*72*70cm

HIGH PRECISION PIPELINE EXTERNAL COUNTERPART PLIERS

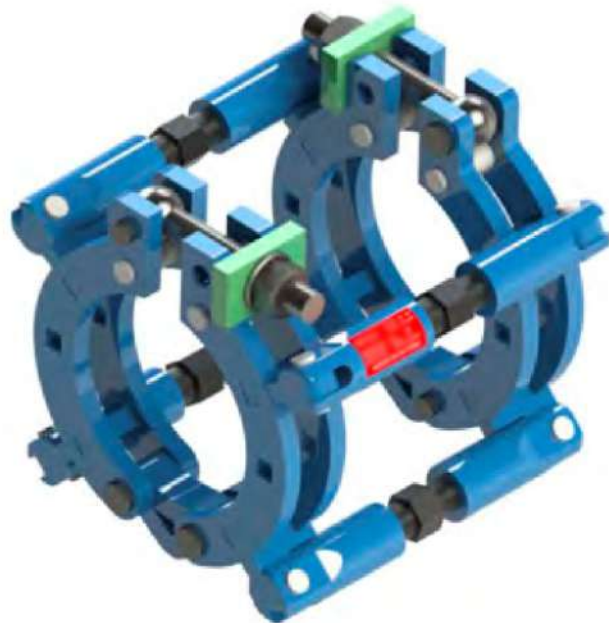

Main Performance

Pipeline external counterpart Pliers is an essential equipment for pipeline welding or install operation. High precision counterparts Pliers can improve welding quality and construction efficiency. It is widely used in pipeline connection, pipeline group pairing, pipe fitting installation, pipeline construction etc.

Feature:

- 1. The material is strong steel, high strength, durable
- 2. No external power source, low cost and easy operation
- 3. Overhead design to leave enough space for welding
- 4. Clearance can adjusted, high precision
- 5. Self-locking screw design, strong clamping force
- 6. Can be applied to pipe joints of different materials (carbon steel, stainless steel, composite pipe, etc.)

Engineering Case:

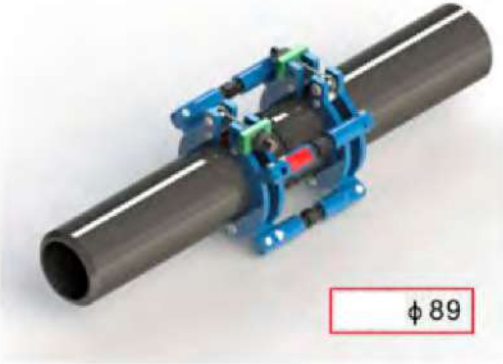
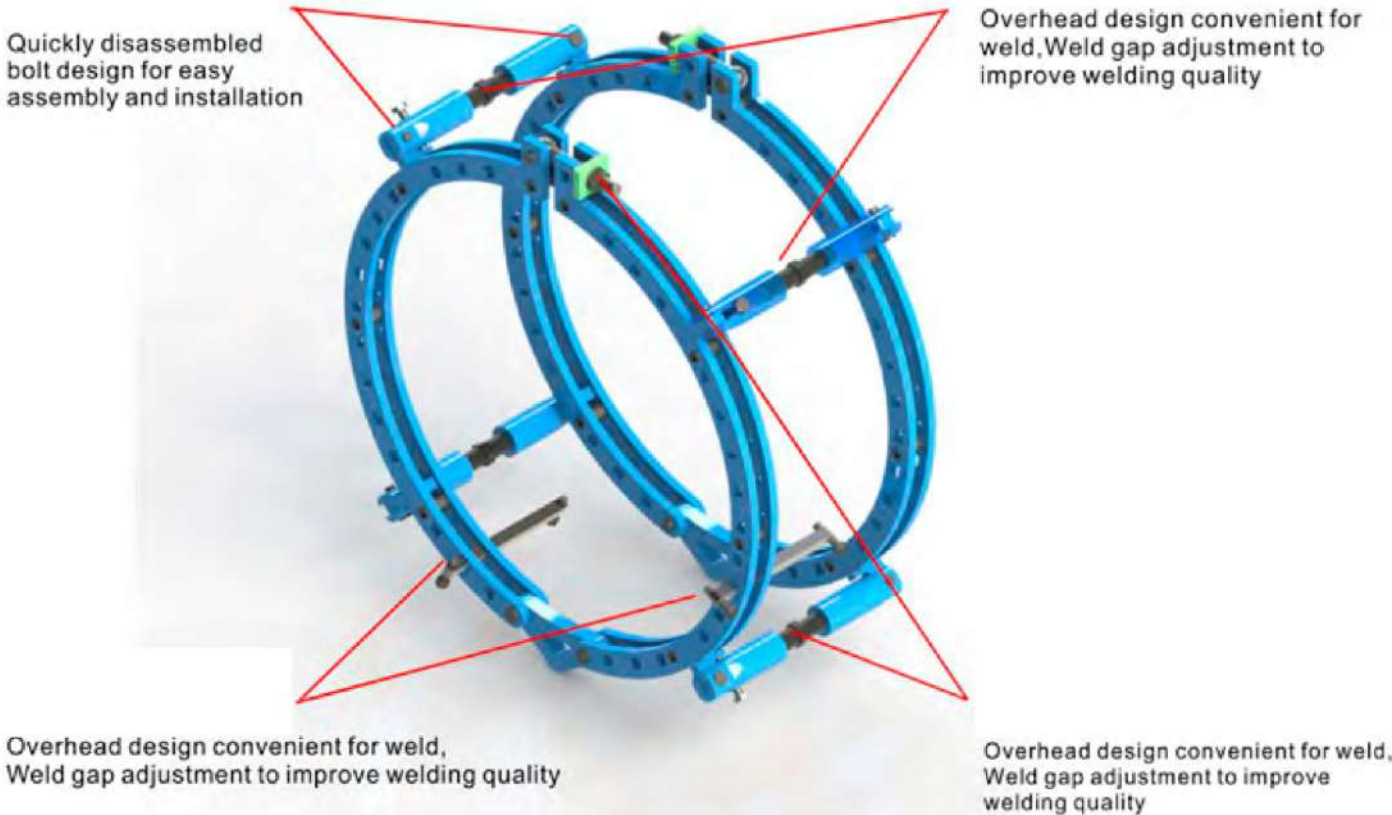

One-to-one design, No adjustment, High efficiency. Working Range is 2"-6" (Different Size can be customized)